

# MOI4-RES-REC

(MOI4-RES-REC-P4-C4 Shown)

Ordering Information	Description:
<b>Slab Thickness:</b>	 <b>LEW ELECTRIC FITTINGS COMPANY</b>  <b>877-537-2019</b> <a href="http://www.lewelectric.com">www.lewelectric.com</a>
Single Rec: <input type="checkbox"/> 15A <input type="checkbox"/> 20A	
Duplex Rec: <input type="checkbox"/> 15A <input type="checkbox"/> 20A	
<b>Cover Type:</b>	
<p align="center"><b>Proprietary and Confidential</b></p> <p>The information contained in this drawing is the sole property of NOCOM. Any reproduction in part or as a whole without the written permission of NOCOM is prohibited.</p>	<b>DWG. No.</b> MOI4-RES-REC

# MOI4-RES-REC Configurations with Bottom Plate

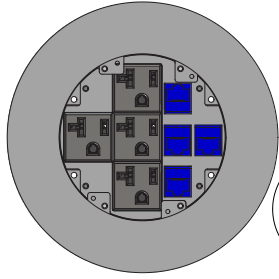

MOI4-RES-REC-P4-C4

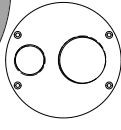

NPS 0.75"  
NPS 1.25"

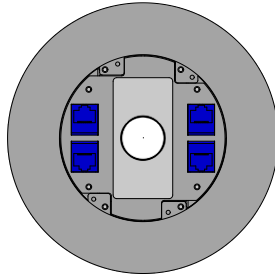

MOI4-RES-REC-AV-C4

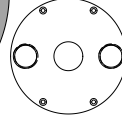

NPS 0.75"  
NPS 0.50" x2

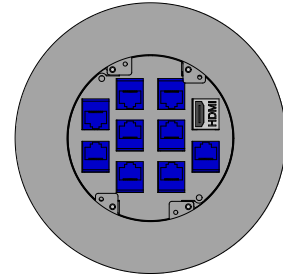

MOI4-RES-REC-C10

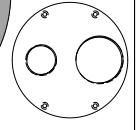

NPS 0.75"  
NPS 1.25"

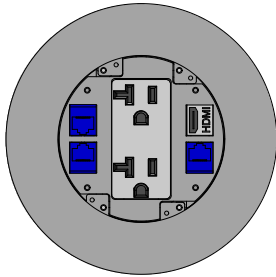

MOI4-RES-REC-DP-C4

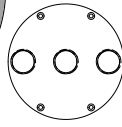

NPS 0.50" x3

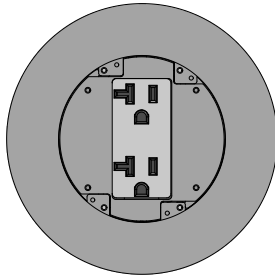

MOI4-RES-REC-DP

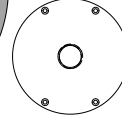

NPS 0.50"

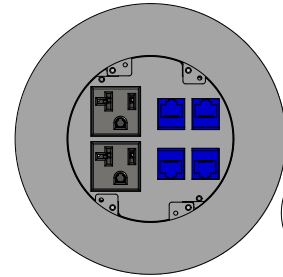

MOI4-RES-REC-P2-C4

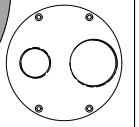

NPS 0.75"  
NPS 1.25"

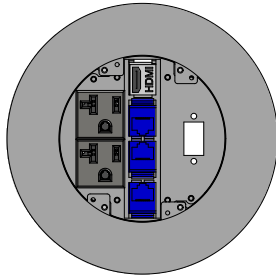

MOI4-RES-REC-P2-C4-DB15

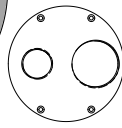

NPS 0.75"  
NPS 1.25"

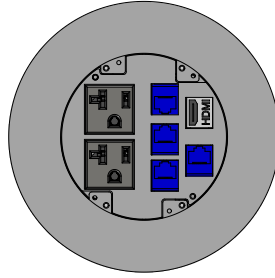

MOI4-RES-REC-P2-C5

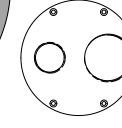

NPS 0.75"  
NPS 1.25"

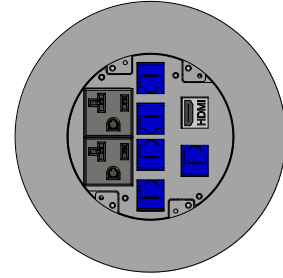

MOI4-RES-REC-P2-C6

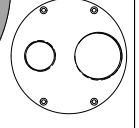

NPS 0.75"  
NPS 1.25"

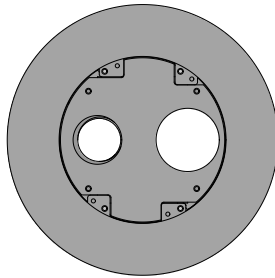

MOI4-RES-REC-SYS-COMM

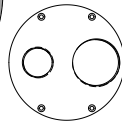

NPS 0.75"  
NPS 1.25"

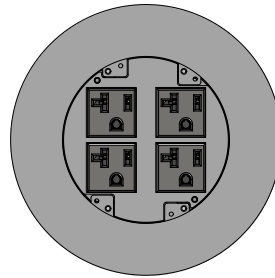

MOI4-RES-REC-P4

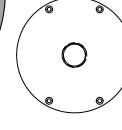

NPS 0.50"

Ordering Information	Description:
<b>Slab Thickness:</b> Single Rec: <input type="checkbox"/> 15A <input type="checkbox"/> 20A Duplex Rec: <input type="checkbox"/> 15A <input type="checkbox"/> 20A <b>Cover Type:</b> Proprietary and Confidential The information contained in this drawing is the sole property of NOCOM. Any reproduction in part or as a whole without the written permission of NOCOM is prohibited.	 <b>877-537-2019 www.lewelectric.com</b> DWG. No. MOI4-RES-REC

# Articulated Hinge Cover with Cable Exit Door (AHC-CED)

Cover Fully Closed

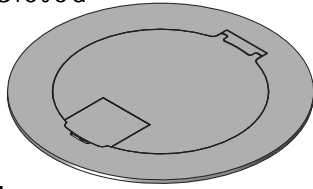

Cover CED Open

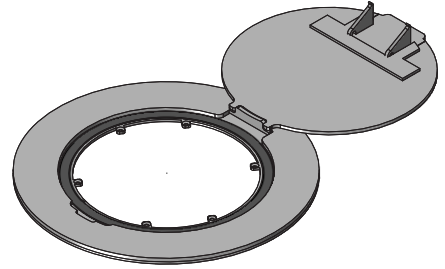
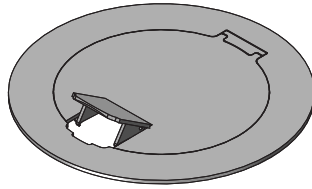

Cover Fully Open

## Cover Finishes

Standard = Brushed Stainless Steel

\*Custom = Brushed Brass

or

Black Matte

\*Additional cost may apply

\*Other colours/finishes available upon request

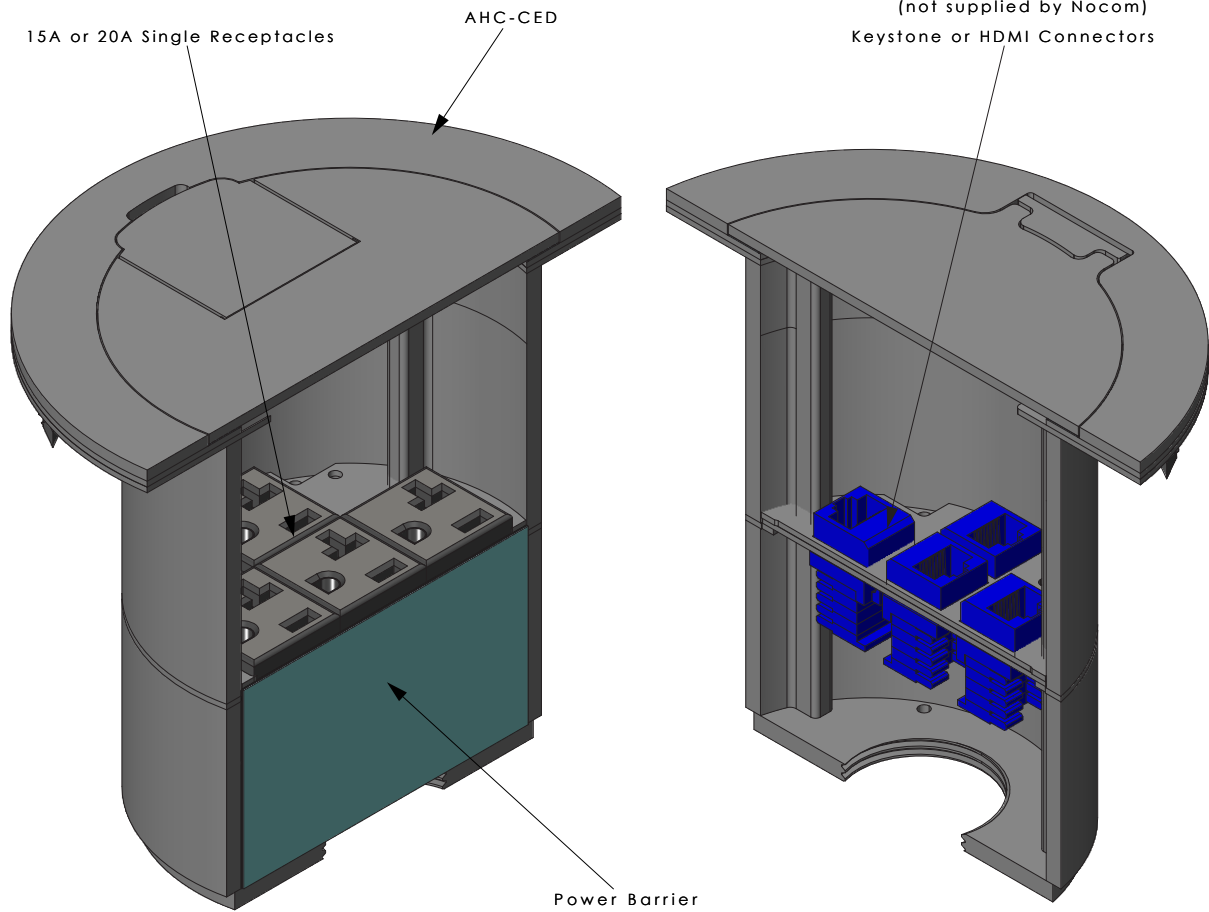

(MOI4-RES-REC-P4-C4 Shown)

Ordering Information	Description:
<b>Slab Thickness:</b> Single Rec: <input type="checkbox"/> 15A <input type="checkbox"/> 20A Duplex Rec: <input type="checkbox"/> 15A <input type="checkbox"/> 20A <b>Cover Type:</b> Proprietary and Confidential The information contained in this drawing is the sole property of NOCOM. Any reproduction in part or as a whole without the written permission of NOCOM is prohibited.	 <b>LEW ELECTRIC FITTINGS COMPANY</b>  877-537-2019 <a href="http://www.lewelectric.com">www.lewelectric.com</a>  DWG. No. MOI4-RES-REC

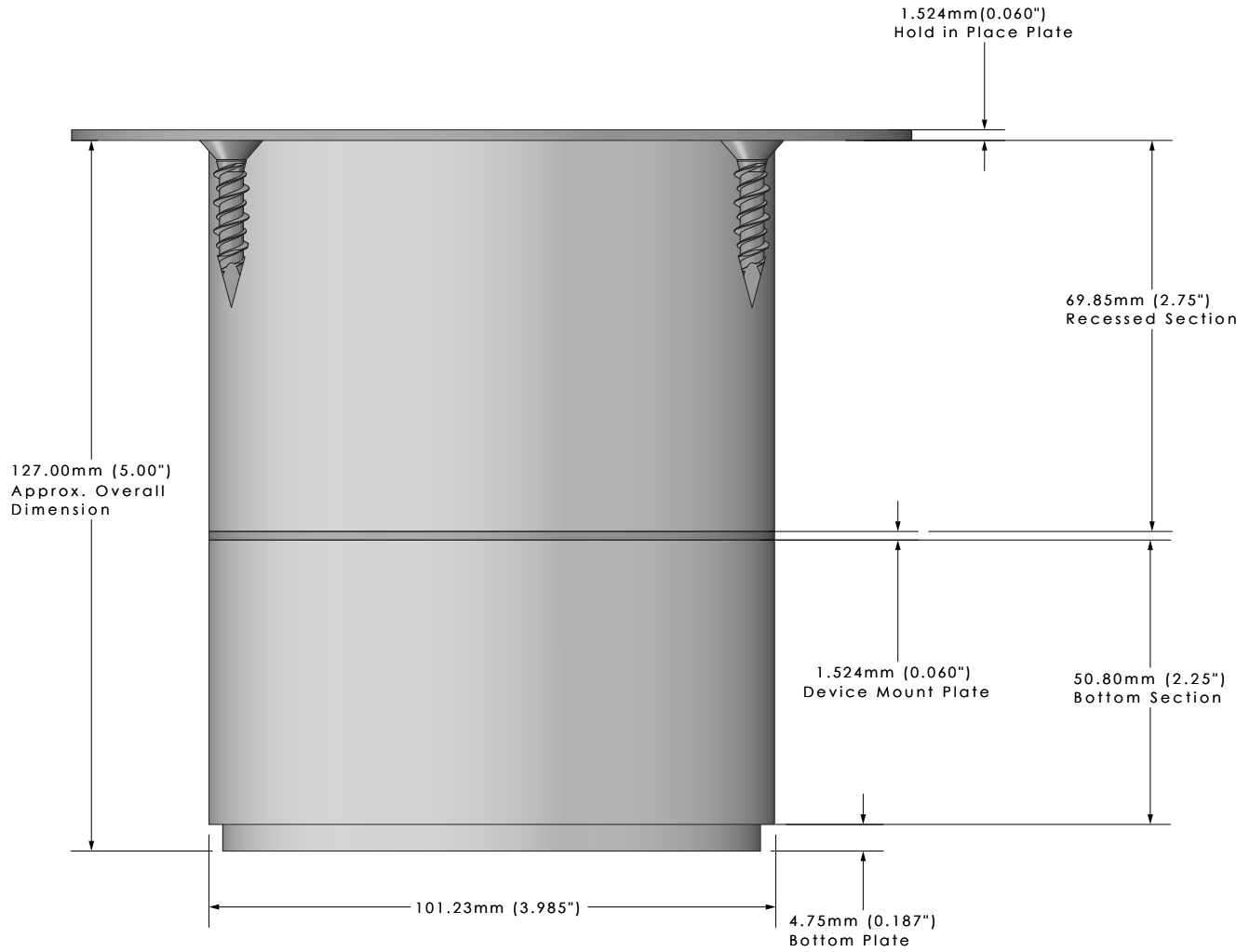

Note: Core hole to be  $\varnothing 107.95"$  (4.25")

Ordering Information	Description:
<b>Slab Thickness:</b>	 <b>LEW ELECTRIC FITTINGS COMPANY</b>
Single Rec: <input type="checkbox"/> 15A <input type="checkbox"/> 20A	
Duplex Rec: <input type="checkbox"/> 15A <input type="checkbox"/> 20A	<b>877-537-2019</b> <a href="http://www.lewelectric.com">www.lewelectric.com</a>
<b>Cover Type:</b>	DWG. No.
<b>Proprietary and Confidential</b>	<b>MOI4-RES-REC</b>
The information contained in this drawing is the sole property of NOCOM. Any reproduction in part or as a whole without the written permission of NOCOM is prohibited.	