



(PUR 2.0 MODEL) POP UP RECEPTACLE INSTALLATION INSTRUCTIONS

FOR CATALOG NUMBERS: All PUR (2.0 MODEL) Series Assemblies

IMPORTANT: Read all instructions before installing the PUR 2 SERIES pop ups.

PRIOR TO INSTALLATION

- Contact a local electrical inspector to make sure that this product meets or exceeds all local electrical codes (electric codes may vary by location).
- Make sure there is adequate space to install (see below: CUT OUT AND MOUNTING STEPS)
- Disconnect and turn off all power sources.
- This product includes a soft wire. Please be aware that removing this wire will void the warranty.
- A small sticker has been placed on the product where the wire is. Removing this sticker will also void the warranty.

***** LEW ELECTRIC FITTINGS ACCEPTS NO RESPONSIBILITY IF ABOVE AND BELOW CONDITIONS ARE NOT MET/FOLLOWED ***.**

- For indoor use only.
- This product is designed for countertops, desktops, and similar surfaces (this product is not suitable for floor use).
- All non GFI units must be wired to a GFCI circuit breaker if being installed in a kitchen, bathroom or any other area where the potential for water is present.
- Only licensed, insured, and bonded electrical contractors should install the PUR series.
- These products have no field serviceable parts. If the product is damaged, it must be returned to the factory. Any attempt to alter this product in any way may cause electrocution.

CUTOUT AND MOUNTING STEPS

- Select the desired location of the countertop or desktop at least 10" from stove top or other heating sources.
- The selected location must be at least 15mm(0.59") away from the edge of the countertop or similar surface.
- The mounting surface must be between 9.5mm(3/8") and 55mm(2 3/16") thick and have the below clearances:

PUR15: ACD, ACQD PUR20: ACD, ACQD, GD, GQD, DSD, DSQD		PUR20: GACD, GACQD, ACBTD, ACBTQD		PUR20: GACBTD, GACBTQD		PUR15: AC2PD, AC2PQD PUR20: AC2PD, AC2PQD, AC2PIQD, AC2PIQQD	
In-Use Height	5.17 "	In-Use Height	7.14 "	In-Use Height	9.10 "	In-Use Height	10.48 "
Closed Position Under Counter Depth (For a 3 cm thick countertop)	8.5"	Closed Position Under Counter Depth (For a 3 cm thick countertop)	12.5 "	Closed Position Under Counter Depth (For a 3 cm thick countertop)	14.5"	Closed Position Under Counter Depth (For a 3 cm thick countertop)	16 "
Minimum Width needed under counter for flange	4.53 "	Minimum Width needed under counter for flange	4.53 "	Minimum Width needed under counter for flange	4.53 "	Minimum Width needed under counter for flange	4.53 "

1. Cut hole in the surface of countertop 95.25mm (3 ¾ ").
2. Remove protective sleeve from cover and discard.
3. Remove plastic threaded locking flange from PUR unit.
4. Feed PUR 2 wiring through the hole in countertop first, followed by PUR unit, pushing down until black gasket rests on the countertop.
5. Feed PUR 2 wiring through the plastic locking flange and thread the flange counterclockwise until locked in place against bottom of the countertop.
6. The product supports top cover replacement. When replacing the top cover, to ensure a smooth installation, please install the top cover first, and then put the O-ring back beneath the top cover.

ELECTRICAL WIRING STEPS

IMPORTANT: A listed junction box (not included) is required for the electrical wiring of the PUR unit.

Ensure that only a licensed electrician should install the junction box and connect the wires.

1. Install the junction box to the wall near the PUR unit.

IMPORTANT:

Please pay special attention to the distance between the junction box and the PUR unit.

Ensure that the soft wire can still have some slack when the PUR unit is in the fully popped position.

2. Run approved conduit/wiring from the electrical panel into the side of the junction box furthest from the PUR unit.
3. Install a connector to the side of the junction box closest to the PUR unit.
4. Install the end of the soft wire from the PUR unit through the connector and into the junction box.
5. Using standard electrical installation practices, connect the wires from the soft wire to the wires from the AC power supply inside the junction box. Then install the cover to the junction box.

OPERATION STEPS:

1. To open pop up feature, press firmly on the cover. The unit will deploy upward approximately 1" initially, then pull cover upward until the unit locks into place.
2. To close the device, push the black plastic locking tab and push down on the cover until the unit locks.

*****Please avoid using excessive force when pushing to open or close the unit.*****

NOTE FOR WIRELESS CHARGING:

TYPE	BUZZER
Standby	2 Beeps
Charging	1 Beep
OTP (Over-Temperature Protection) OVP (Over Voltage Protection) OCP (Over Current Protection)	Long Beep 5 minutes
FOD (Foreign Object Detection)	Long Beep 5 minutes

NOTE CONNECTION STEPS FOR BLUETOOTH SPEAKERS:

1. Press and hold the power button for 5 seconds until you hear a "Power on" sound.
(Also, Press and hold the power button for 5 seconds until you hear a "Power off" sound, it means that the Bluetooth speaker has been turned off.)

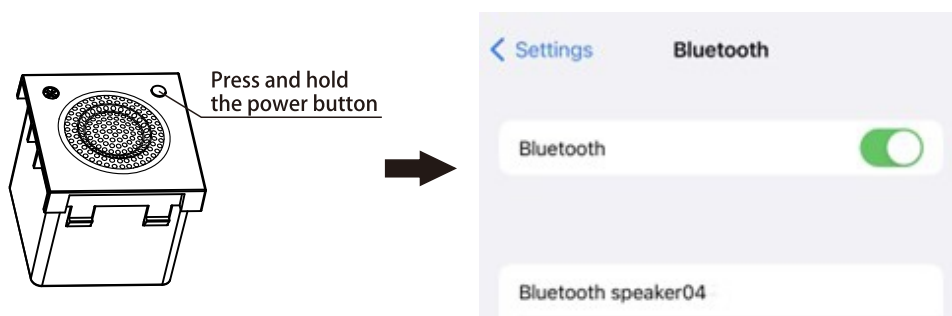

2. On the Bluetooth configuration of your mobile phone, connect your phone with the device named "Bluetooth speaker 04".
3. When hearing the "Connected" sound, it means the Bluetooth speaker has been paired successfully.

NOTE CONNECTION STEPS FOR STEREO BLUETOOTH SPEAKERS:

1. Please make sure you have 2 Bluetooth speakers. (Note: Cannot exceed two speakers)
2. Press and hold power buttons one by one for 5 seconds until you hear a "Power on" from each Bluetooth speaker.
3. Double-click the power button of one of the Bluetooth speakers. When hearing the "Connected" sound, it means the two speakers have been paired successfully.
4. On the Bluetooth configuration of your mobile phone, connect your phone with the device named "Bluetooth speaker 04" until you hear a "Connected" sound.

NOTE: Countertop unit must be cut in as specified. In order for unit to deploy, the metal flange must be on top of countertop to create counter pressure.

For further instruction, please visit our website at www.lewelectric.com to review the installation video. Or, use your smart phone to read the QR code from the product label to access the video.

